

MEFR9942 Auto-Lift Four Roll Two Roll Geared Wire Drive System

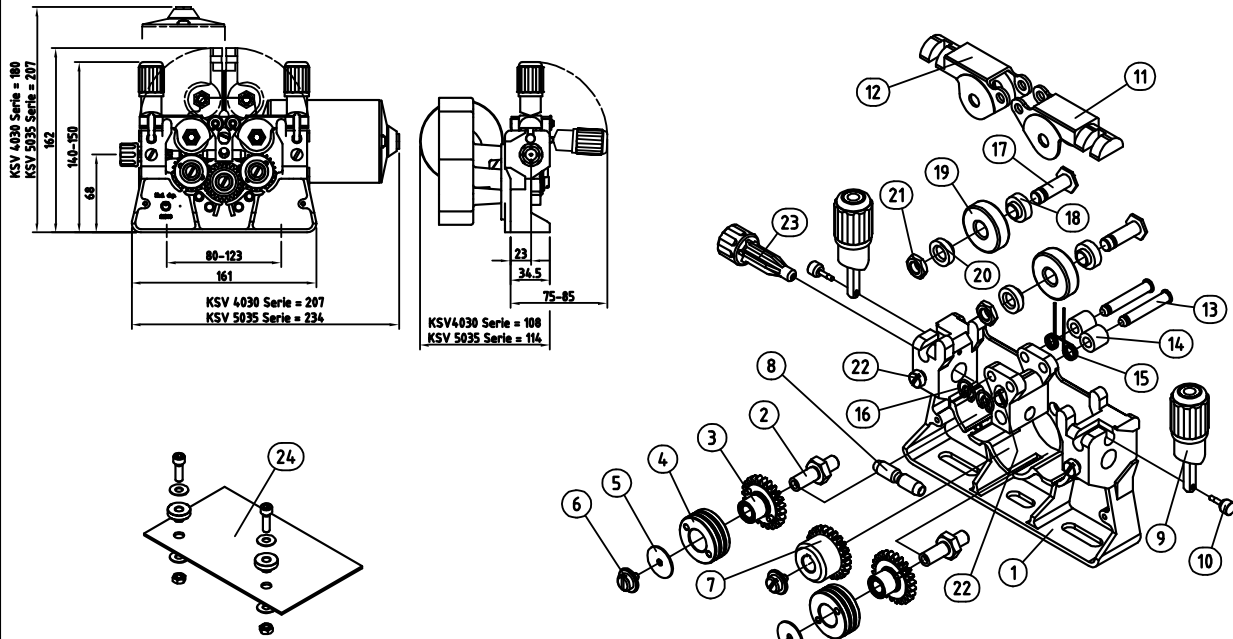

MEFR9942 Auto-Lift Consumable and Replacement Parts List

Item	Part No.	Description	Qty.	Item	Part No.	Description	Qty.
1	62300	Feed Plate	1				
2	74768	Axle Shaft Gear Adaptor Feed Roll	1			74000 Feed Roll Range	
3	74783	Gear Adaptor Feed Roll	1				
4	74109	Feed Roll V-Groove 1,0mm + 1,2mm	1	74238	Feed Roll V-Groove 0,6mm + 0,8mm	1	
5	74770	Washer [Ref. 74770-1]	1	74129	Feed Roll V-Groove 0,8mm + 1,0mm	1	
6	62037	Retaining Screw Feed Roll	1	74109	Feed Roll V-Groove 1,0mm + 1,2mm	1	
7	74789	Main Gear Drive to KSV5035 Motors	1	74102	Feed Roll V-Groove 1,2mm + 1,6mm	1	
7A	74306	Main Gear Drive to KSV4030 Motors	opt.	74917	Feed Roll V-Groove 0,9mm + 1,2mm	1	
8	62287	Intermediate Guide 0,6mm - 1,6mm Wire	1	74919	Feed Roll U-Groove 0,8mm + 0,9mm A	1	
8A	62286	Intermediate Guide 1,6mm - 3,2mm Wire	opt.	74796	Feed Roll U-Groove 1,0mm + 1,2mm A	1	
8B	62285	Intermediate Guide Super Glide 0,6mm - 1,6mm Wire	opt.	74797	Feed Roll U-Groove 1,2mm + 1,6mm A	1	
8C	62284	Intermediate Guide Super Glide 1,6mm -3,2mm Wire	opt.	74798	Feed Roll U-Groove 2,4mm + 3,2mm A	1	
9	62612	Pressure Device with Scale	1	74918	Feed Roll U-Groove 1,6mm + 2,0mm A	1	
10	62294	Pin	1	74107	Feed Roll U-Groove 0,8mm + 1,0mm A	1	
11	62684	Pressure Arm Right Hand	1	74104	Feed Roll U-Groove ,035 + 3/64 inch A	1	
12	62683	Pressure Arm Left Hand	1	74289	Feed Roll V-Groove 1,0/1,2mm + 1,4/1,6mm Knurled	1	
13	62083	Locating Pin Pressure Arm	1	74251	Feed Roll V-Groove 1,4/1,6mm + 2,0/2,4mm Knurled	1	
14	62289	Spacer Tube Pressure Arm Auto-Lift	1	74191	Feed Roll V-Groove 2,8/3,2mm Knurled	1	
15	62293	Spring Pressure Arm Auto-Lift	1	74290	Feed Roll V-Groove 1,6mm + 1,6mm Knurled	1	
16	62035	Circlip	1	74913	Feed Roll V-Groove 1,0/1,2mm + 1,0/1,2mm Knurled	1	
17	62288	Axle Pressure Roll	1	74105	Feed Roll V-Groove ,045/0,52 + 1/16 inch Knurled	1	
18	62296	Spacer large	1				
19	62012	Pressure Roll	1			FHP-Elmotor Wire Feed Motors	
20	62013	Spacer small	1				
21	62015	Nut to Axle Pressure Roll	1	80030	KSV 5035-551 24 volts 200 rpm Super Power	1	
22	62078	Screw	Pkt. 5	80031	KSV 5035-552 42 volts 200 rpm Super Power	1	
23	62032	Inlet Guide 0,6mm - 1,6mm Wire	1	80033	KSV 5035-556 Tacho 24 volts 200 rpm Super Power	1	
23A	62047	Inlet Guide 1,6mm - 3,2mm Wire	opt.	80045	KSV 5035-601 Exten. Shaft 42 volts 220 rpm Super Power	1	
23B	62148	Inlet Guide with Wire Guide Tube Blue I.D. 2,0mm	opt.	80050	KSV 5035-555 Tacho 42 volts 270 rpm Super Power	1	
23C	62044	Inlet Guide with Wire Guide Tube Red I.D. 2,5mm	opt.	80047	KSV 5035-601 Tacho 1 volt Super Power 42 volt 220 rpm	1	
23D	62157	Inlet Guide with Soft Liner Tube Red I.D. 2,5mm	opt.	80062	KSV 5035-601 Optic Reader Super Power 42 volt 220 rpm	1	
24	62280	Insulation Mounting Kit 2,0mm thick Base Plate	opt.			Motor Alignment Tool	
	62281	Pressure Arm complete Right Hand MEFR9942	1	62279	Mandrel Tool	1	
	62282	Pressure Arm complete Left Hand MEFR9942	1	62038	Key Motor Shaft	Pkt. 5	
				62039	Snap Ring Motor Shaft	Pkt. 5	
				62292	Allen Screw Motor mounting	Pkt. 5	
						Euro Central Adaptor Systems	
				72012	ME600 Euro Central Adaptor machine-side complete	1	
				100060	ME600 Hexagonal Central Adaptor L=45mm machine-side complete	1	
				100117	ME600 Hexagonal Central Adaptor L=83.5mm machine-side complete	1	
						MEFR9942 Auto-Lift Four Roll Two Roll Geared W.D.S.	
				69150	MEFR9942 Auto-Lift Four Roll Two Roll Geared Wire Drive System, Front release, less Motor, supplied with Feed Roll 1,0 + 1,2mm	1	

Schéma rozložení posuvu pro ATA 350-500 PULS 2 MM014-1					
Vypracoval: Worked out:	DJ 21/1/2010	Přezkoumal: Inspected:	DJ 21/1/2010	Schválil: Approved:	VS 21/1/2010